

| PCEN | REV | APPV | DATE | REVISIONS | OWN | QCON | CHK | APPV |
|------|-----|------|------|-----------------|-----|------|-----|------|
| | | | | INITIAL RELEASE | | | | |

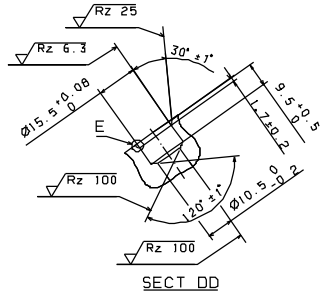

SECT DD

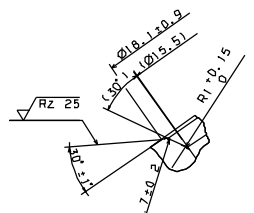

DETAIL E (5:1)

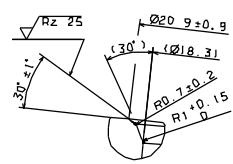

DETAIL F (5:1)

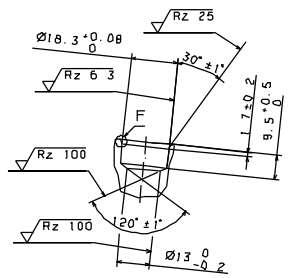

SECT SS

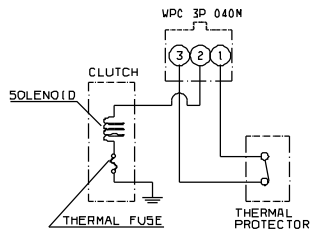

CIRCUIT DIAGRAM

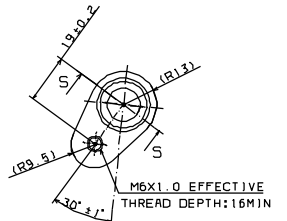

M6X1.0 EFFECTIVE
THREAD DEPTH:16MM

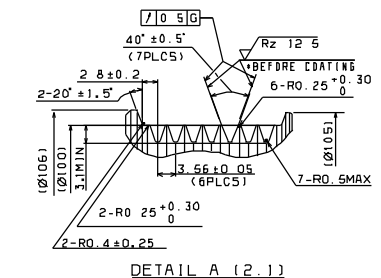
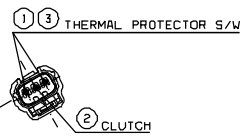
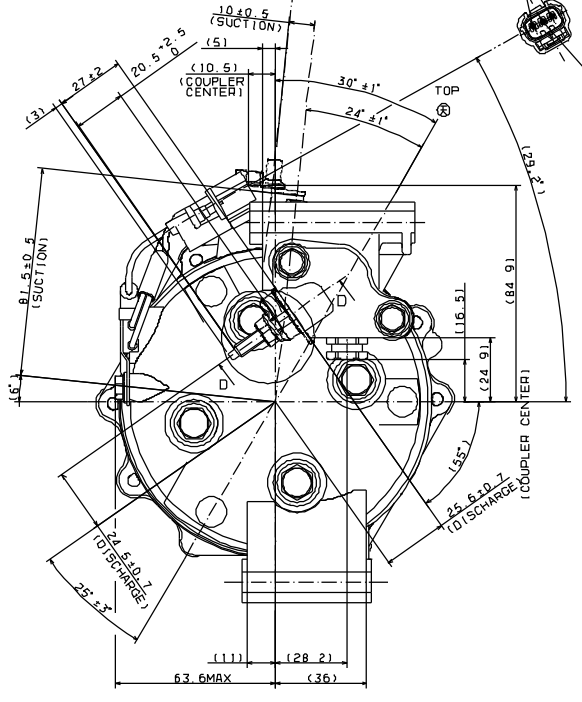
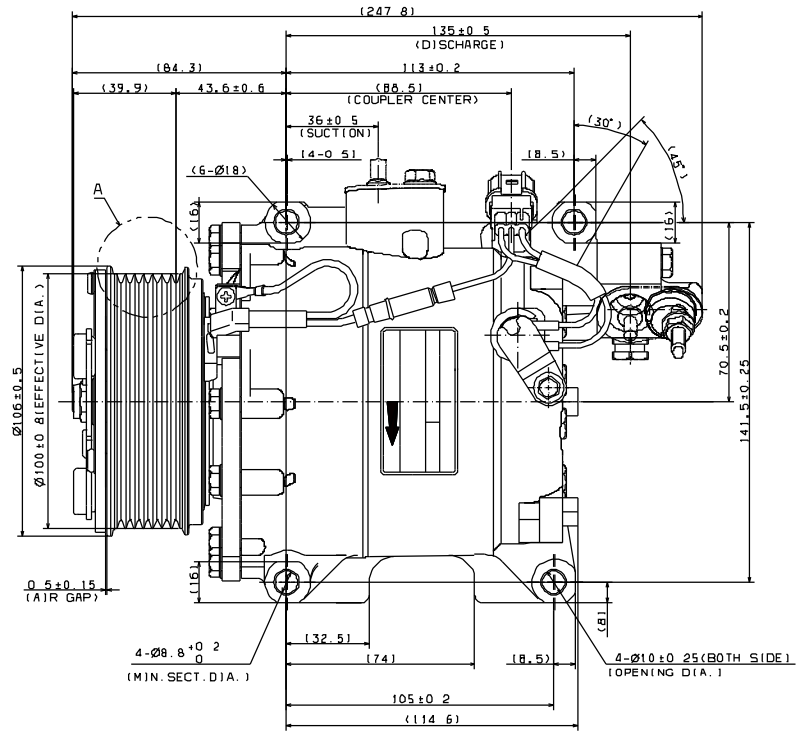
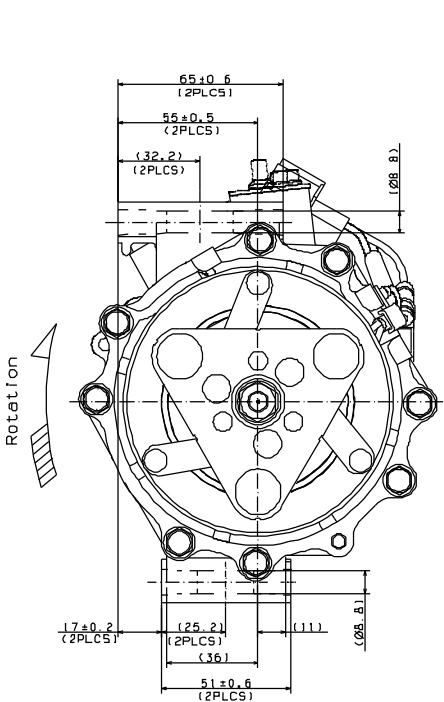

DETAIL A (2:1)

COMPRESSOR SPECIFICATIONS

| | |
|-----------------------------|---|
| Displacement/Rev | 77 l cm ³ /rev. (with Oil Separator) |
| Refrigerating Capacity | 2.64 kW (2270 kcal/hr) MIN. (at 1500rpm) |
| Oil | S P - 1 0 |
| Oil Charge | 75 cm ³ |
| Refrigerant | HFC 134a |
| Rotation (Clutch Side View) | Clock Wise |
| Mass | 4.140 kg (include oil weight) |

CLUTCH SPECIFICATIONS

| | |
|------------------------------------|-------------------------|
| Rated Voltage | DC 12V |
| Breakaway Torque | 24.5 N·m (2.5kgf·m) MIN |
| Power Consumption | 42 W MAX |
| Thermal fuse Operating Temperature | 180°C |
| Mass | 1.810 kg |

THERMAL PROTECTOR SPECIFICATIONS

| | |
|---------------------|--------------|
| Temp Sensor Type | Bi metal |
| Contact Type | Au cross-bar |
| Rated Voltage | DC5V |
| Rated Current | 2.3mA |
| Cut Off Temperature | 125°C ± 3 °C |
| Cut in Temperature | 110°C ± 6 °C |

| | | | | | | | | | |
|---|---|---|---|---|---|---|---|---|--|
| <p>REV. 1: 10/01</p> <p>APPV: J. SONGHSH</p> <p>DATE: 10/01</p> | <p>REV. 2: 10/01</p> <p>APPV: J. SONGHSH</p> <p>DATE: 10/01</p> | <p>REV. 3: 10/01</p> <p>APPV: J. SONGHSH</p> <p>DATE: 10/01</p> | <p>REV. 4: 10/01</p> <p>APPV: J. SONGHSH</p> <p>DATE: 10/01</p> | <p>REV. 5: 10/01</p> <p>APPV: J. SONGHSH</p> <p>DATE: 10/01</p> | <p>REV. 6: 10/01</p> <p>APPV: J. SONGHSH</p> <p>DATE: 10/01</p> | <p>REV. 7: 10/01</p> <p>APPV: J. SONGHSH</p> <p>DATE: 10/01</p> | <p>REV. 8: 10/01</p> <p>APPV: J. SONGHSH</p> <p>DATE: 10/01</p> | <p>REV. 9: 10/01</p> <p>APPV: J. SONGHSH</p> <p>DATE: 10/01</p> | <p>REV. 10: 10/01</p> <p>APPV: J. SONGHSH</p> <p>DATE: 10/01</p> |
| <p>SANDEN</p> <p>SANDEN INTERNATIONAL, CORP. U.S.A.</p> <p>SCALE: REF NONE [X1.0] NONE [METRIC]</p> <p>INTERPRETATION OF THIS DRAWING PER ASME Y14.5M-1994</p> <p>THIRD ANGLE PROJECTION</p> <p>MATERIAL: _____</p> <p>NAME: _____</p> <p>COMPRESSOR</p> <p>DWG. NO. 4919-6000</p> | | | | | | | | | |