

PARTIAL SECT A-A

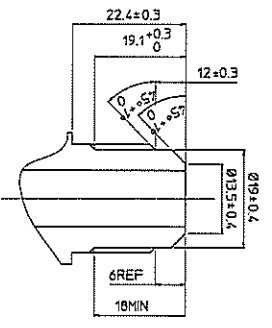

PARTIAL SECT B-B (2-1)

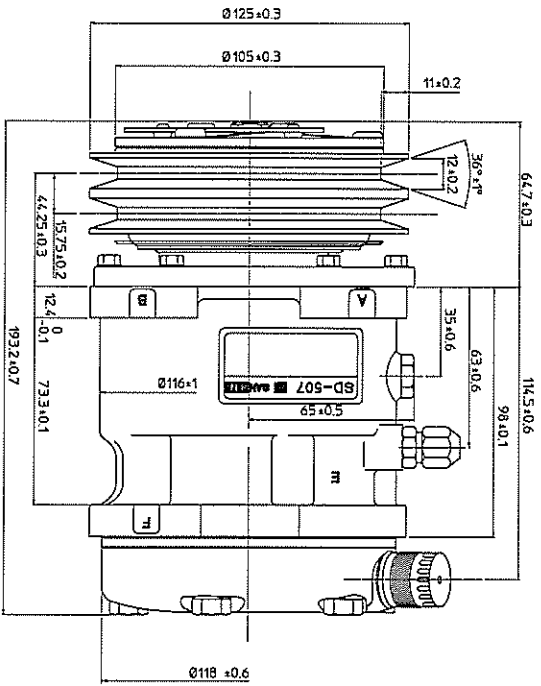
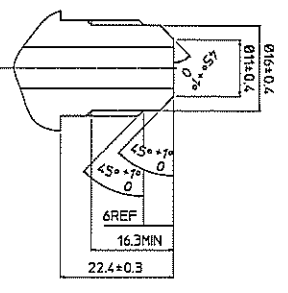
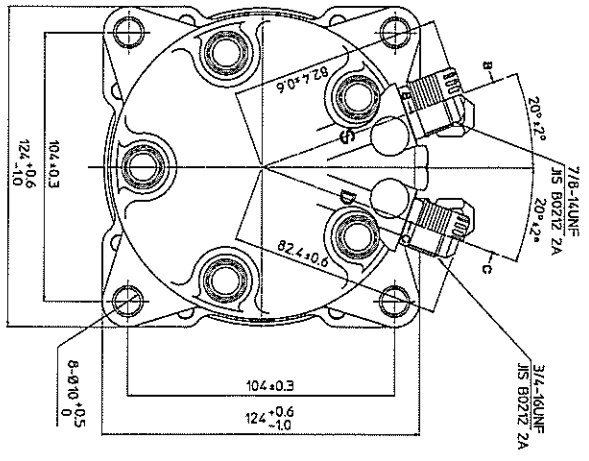

PARTIAL SECT C-C (2-1)

COMPRESSOR SPECIFICATIONS

BORE	935 mm
STROKE	226 mm
DISPLACEMENT PER REVOLUTION	108 cc/rev
NUMBER OF CYLINDERS	5
MAXIMUM ALLOWABLE RPM	7000 RPM
MAXIMUM ALLOWABLE CONTINUOUS RPM	6000 RPM
REFRIGERANT	HFC134a
OLSP-20 OR EQUIV)	35 CC
ROTATION(CLOCKWISE SIDE VIEW)	CLOCKWISE
WEIGHT	4.6 kg

CLUTCH SPECIFICATIONS

RATED VOLTAGE	DC 24 V
BREAKAWAY TORQUE	2.65 kg-m
REPAIR/RE-ENGAGEMENT VOLTAGE	16 V max
POWER CONSUMPTION	34 W (CL)
MAXIMUM ALLOWABLE RPM	7000 RPM
MAXIMUM ALLOWABLE CONTINUOUS RPM	6000 RPM
BELT TYPE	A
PULLEY DIAMETER	Ø125mm
WEIGHT	2.1 kg

DATE	5/11	NAME	COMPRESSOR
SCALE	1:1	PROJECT NO.	SD-507/E5111
REVISED BY		DATE	5/11-6000S
BY		DATE	



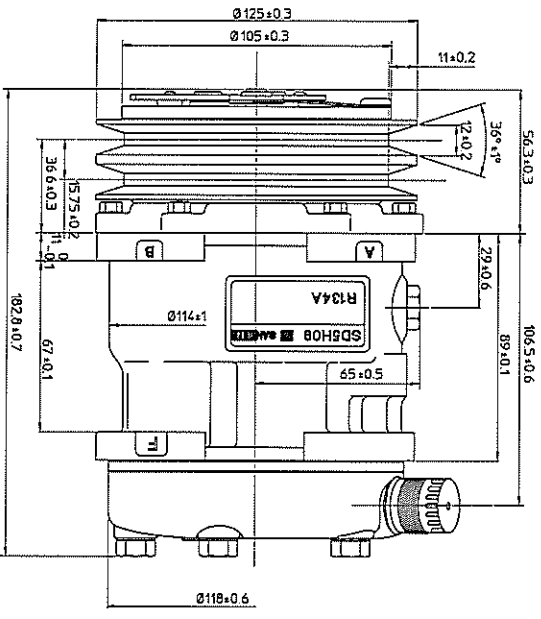
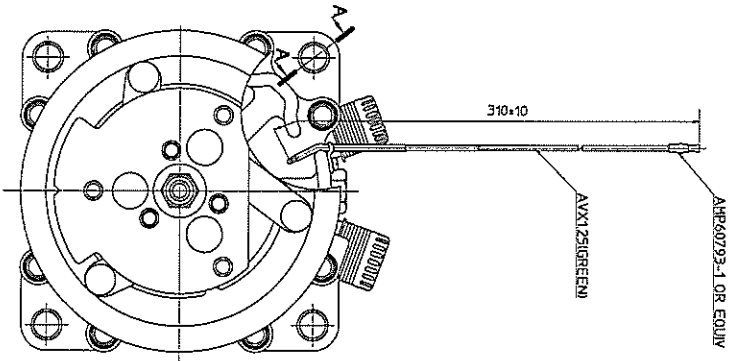

PARTIAL SECT A-A

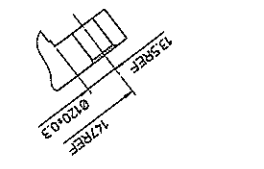

PARTIAL SECT B-B (21)

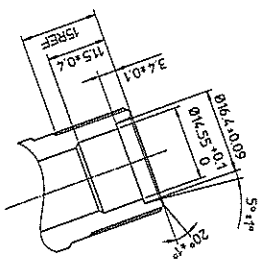

PARTIAL SECT C-C (21)

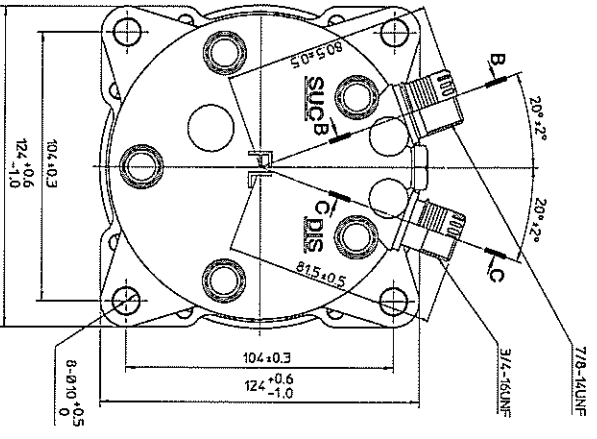
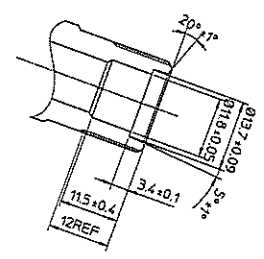

COMPRESSOR SPECIFICATIONS

BORE	035	mm
STROKE	18.07	mm
DISPLACEMENT PER REVOLUTION	87	cc/rev
NUMBER OF CYLINDERS	5	
MAXIMUM ALLOWABLE F.P.D.M.	7500	f.p.m.
MAXIMUM ALLOWABLE CONTINUOUS F.P.D.M.	6500	f.p.m.
REFRIGERANT	R-134a	
OIL (SP-20 OR EQUIV.)	100	cc
ROTATION (CLUTCH SIDE VIEW)	CLOCKWISE	
WEIGHT	4.2	kg

CLUTCH SPECIFICATIONS

RATED VOLTAGE	DC 24 V
BREAKAWAY TORQUE	2.2 kg-m
MINIMUM ENGAGEMENT VOLTAGE	16 V max
POWER CONSUMPTION	34 W (CU)
MAXIMUM ALLOWABLE F.P.D.M.	7500 f.p.m.
MAXIMUM ALLOWABLE CONTINUOUS F.P.D.M.	6500 f.p.m.
BELT TYPE	A2
PULLEY DIAMETER	1725 mm
WEIGHT	2.1 kg

敬請發
23.8.2010
RAYMOND

REVISION	DATE	BY	DATE	MATERIAL	PART NO.	NAME
1				5073S	5073S	COMPRESSOR
2				1-1		
3				Michael	SDSH09FL5073S	
4				DATE	5073-0005	
5						
6						