

PARTIAL SECT. A-A

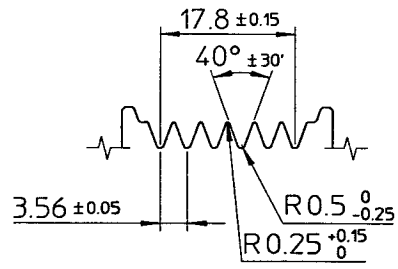

DETAIL OF ROTOR GROOVE(2:1)

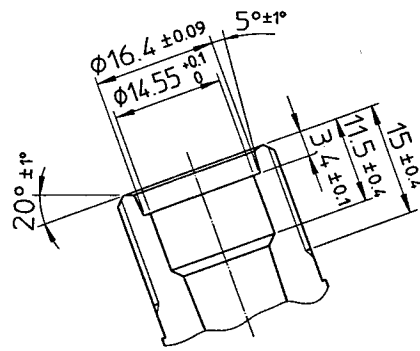

PARTIAL SECT. B-B(2:1)

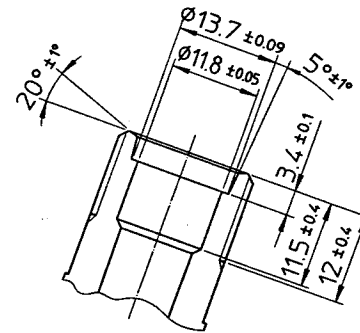

PARTIAL SECT. C-C(2:1)

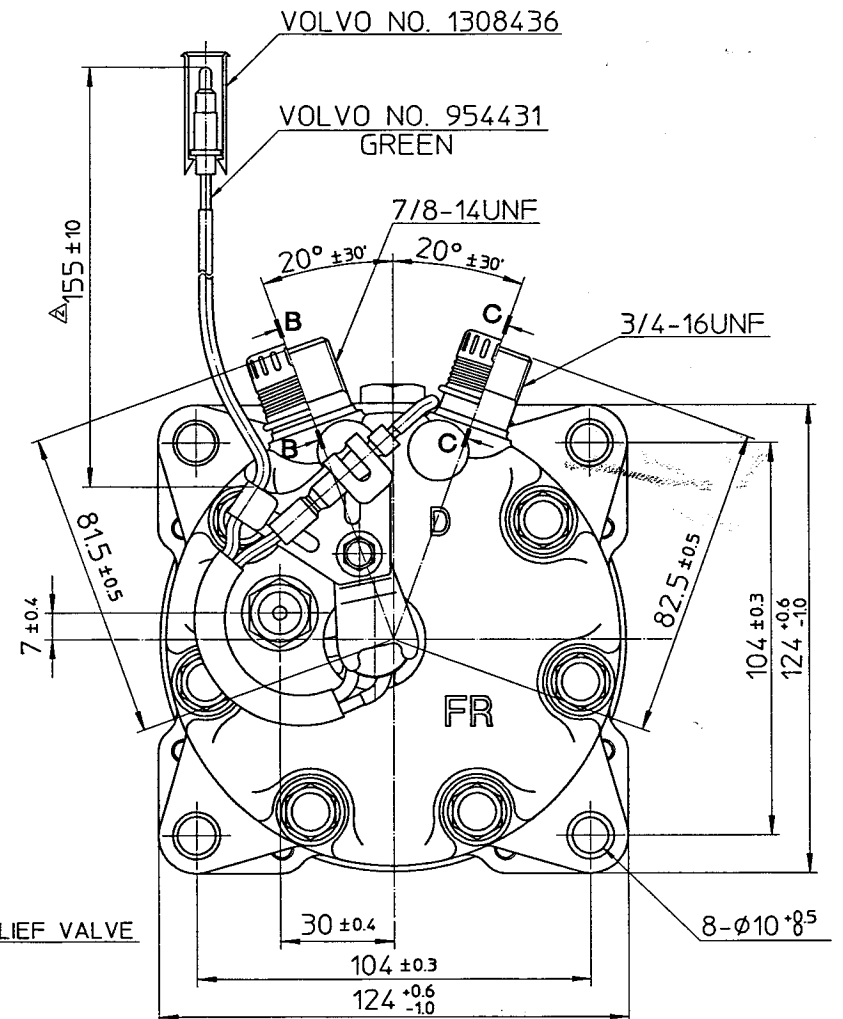
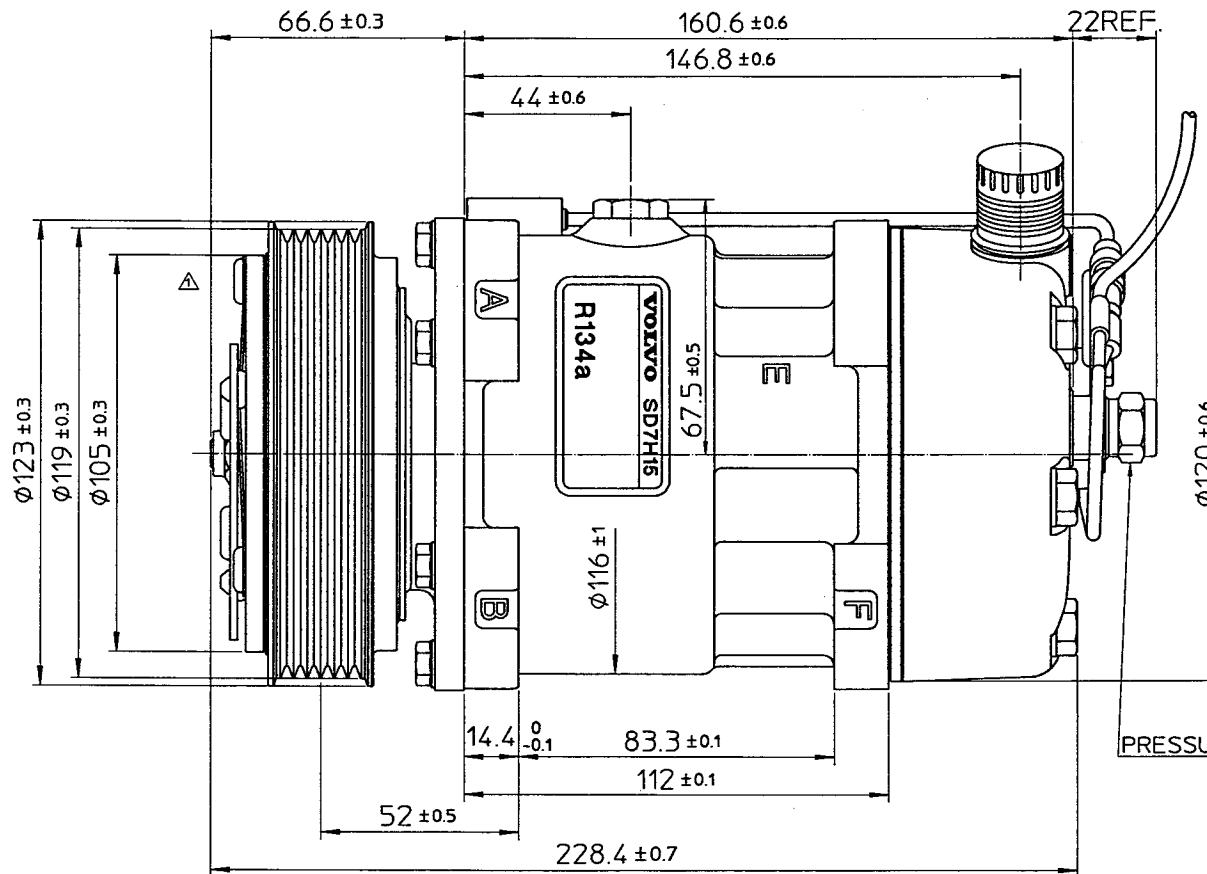
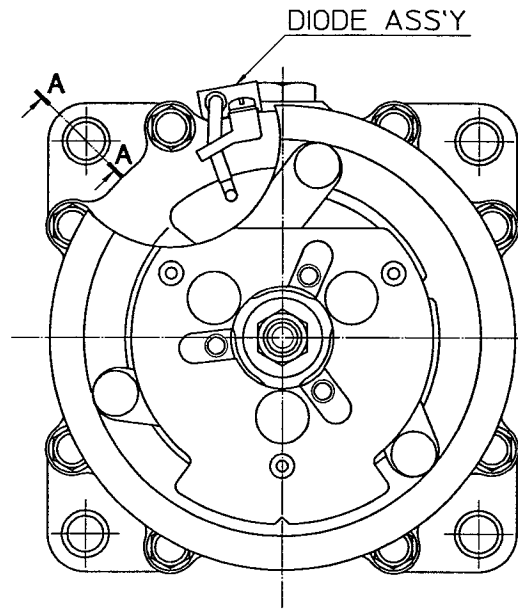
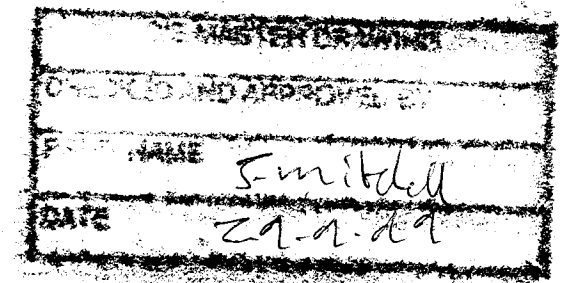

COMPRESSOR SPECIFICATIONS

BORE	∅ 29.3 mm ( 1.15 in.)
STROKE	32.8 mm ( 1.29 in.)
DISPLACEMENT PER REVOLUTION	154.9 cc/rev. ( 9.5 cu.in./rev.)
NUMBER OF CYLINDERS	7
MAXIMUM ALLOWABLE r.p.m.	7000 r.p.m.
MAXIMUM ALLOWABLE CONTINUOUS r.p.m.	6000 r.p.m.
REFRIGERANT	R-134a
∆ OIL : SP-20 OR EQUIV.	240 cc ( 8.2 fl.oz.)
WEIGHT	5.0 kg ( 11.0 lb)

CLUTCH SPECIFICATIONS

RATED VOLTAGE	DC 12 V
BREAKAWAY TORQUE	3.5 kg-m ( 25.3 ft-lb)
MINIMUM ENGAGEMENT VOLTAGE	7.5 V MAX.
POWER CONSUMPTION	49 W ( CU )
MAXIMUM ALLOWABLE r.p.m.	7000 r.p.m.
MAXIMUM ALLOWABLE CONTINUOUS r.p.m.	6000 r.p.m.
BELT TYPE	PV TYPE
PULLEY DIAMETER	∅119 mm ( 4.7 in.)
WEIGHT	2.4 kg ( 5.3 lb)

THERMAL PROTECTOR SPECIFICATIONS

TYPE	BIMETAL
CUT OFF TEMPERATURE	115°C ± 3°C
DIFFERENTIAL	15°C REF.
CUT IN TEMPERATURE	100°C ± 6°C

BOLT SURFACE TREATMENT SPECIFICATION

Fe/Zn 5µ BLACK CROMATE

PRESSURE RELIEF VALVE SPECIFICATION

RELIEVED PRESSURE : 38 ± 3bar

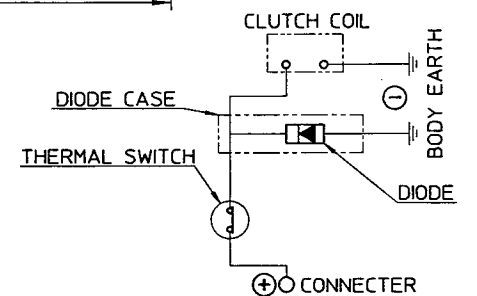

CIRCUIT DIAGRAM

UNCONTROLLED COPY

∆				MATERIAL	PART NO.	7828	NAME	COMPRESSOR
∆				THIRD ANGLE PROJECTION	SCALE	1:1		
∆	OIL CHANGE ( SP-1 → SP-20 OR EQUIV.)	TH	30 Aug 93	DESIGN BY	DATE	31 Aug 1993	MODEL	SD7H15FR7828
∆	CABLE LENGTH CHANGE ( 185 ± 10 → 155 ± 10 )	TH	21 Apr 92	CHECKED BY	DATE	2 SEP 1993	DRAWING NO.	7828-6000
∆	ARMATURE CHANGE	TH	29 Jan 92	CHECKED BY	DATE	2 SEP 1993		C
NO.	REVISION RECORD		BY	DATE				